

ON DWG

THIS DRAWING IS PROPRIETARY TO DSS
NO PART OF THIS DRAWING MAY BE REPRODUCED
WITHOUT THE PERMISSION OF DSS
이 기밀로써 복제할 수 없음

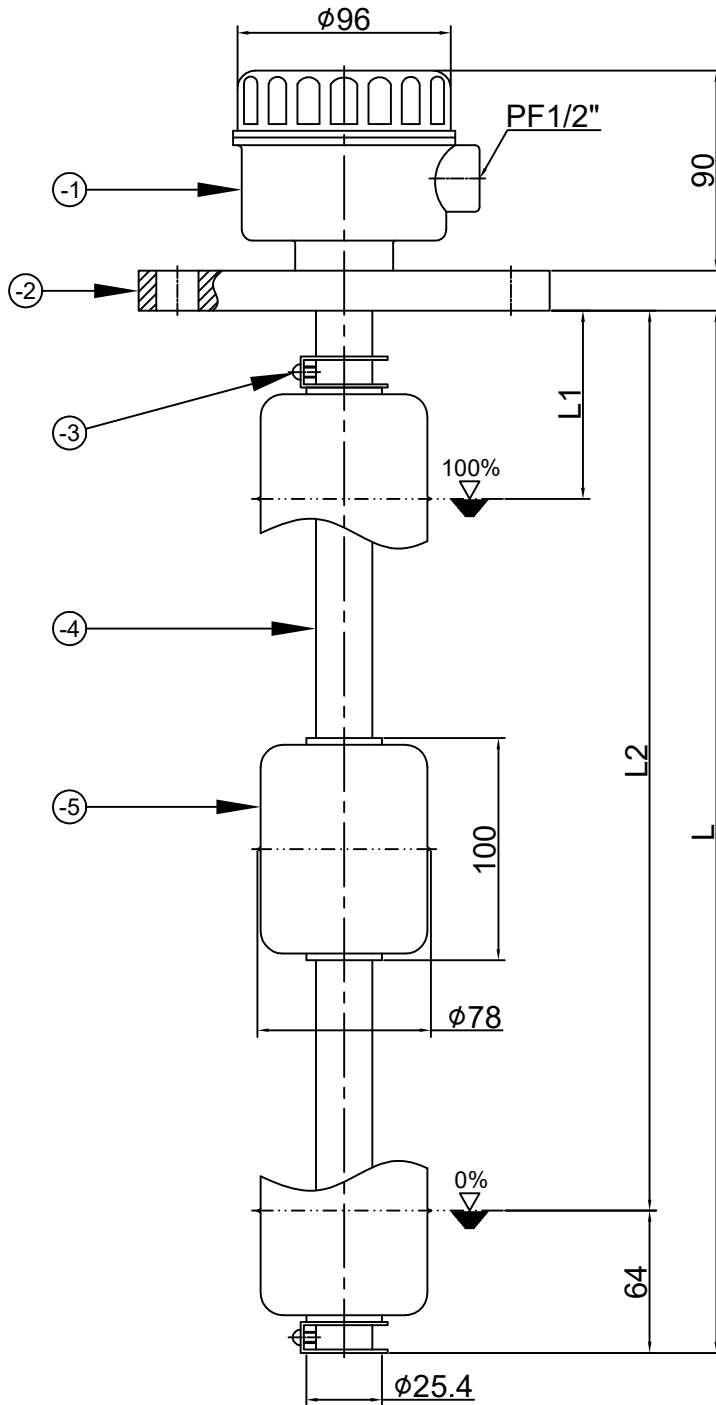

(UNIT:mm)

ITEM NO	PART NAME	QTY	MATERIAL
-5	FLOAT	1	SUS304
-4	PIPE	1	SUS304
-3	STOPPER	2	SUS304
-2	FLANGE	1	SUS304
-1	HEAD	1	A.B.S
1	DT-200S1	1	-

SPECIFICATION	
MODEL NAME	DT-200S1
PRESSURE	MAX. 5Kgf/cm ²
TEMPERATURE	MAX. -10 ~ +60°C
APPLICATIONS	WATER, OIL, MEDICAL LIQUID
OUTPUT SIGNAL	4~20mA
INPUT SINGAL	DC24V
MOUNTING METHOD	TOP
MOUNTING SIZE	ORDER MADE
MATERIAL	SUS304 / 316
REMARKS :	ORDER MADE(L1, L2, L=L2+64)

배부처

NO	DATE	REVISION	APPD BY	TOLERANCES-UNLESS OTHERWISE SPECIFIED				DONG SUNG SENSORS CO., LTD. TEL:(02)2101-0688-9 FAX:(02)2101-0687	UNIT	MM, INCH	APPAR.	-
1	2014.01.27	INITIAL RELEASE	K.B. HAN	WORK SIZE	TURN PUNCH DIST OF HOLE STR.	MILDG. DIE CSTG. PRICK. CSTG. DRAW.	SHMET WELD GAS CTG.		CSTG. FORG.	SCALE	N / S	TITLE
4	16	±0.1	±0.2	±0.3	±0.5	±0.7	±0.9	±1.3	3RD ANGLE	3 각 법	DWG. NO	-
16	63	±0.3	±0.4	±0.7	±1.3	±1.8	±2.5	±3.3	REF. NO	참고도면	도면번호	1/1
63	250	±0.4	±0.5	±1.2	±1.8	±2.5	±3.3	±4.0	DATE	2019.08.01.		
250	500	±0.6	±0.8	±1.5	±2.0	±2.5	±3.3	±4.0				
500	1000	±0.8	±1.0	±2.0	±2.5	±3.3	±4.0	±5.0				
1000	2000	±1.2	±1.5	±2.5	±3.3	±4.0	±5.0	±6.0				
		ANGLE	±.25°	±.5°	±1.0°	±2.0°						