

ON DWG
 -

THIS DRAWING IS PROPRIETARY TO DSS
 NO PART OF THIS DRAWING MAY BE REPRODUCED
 WITHOUT THE PERMISSION OF DSS
 ©기밀인쇄물 무단복사 금지

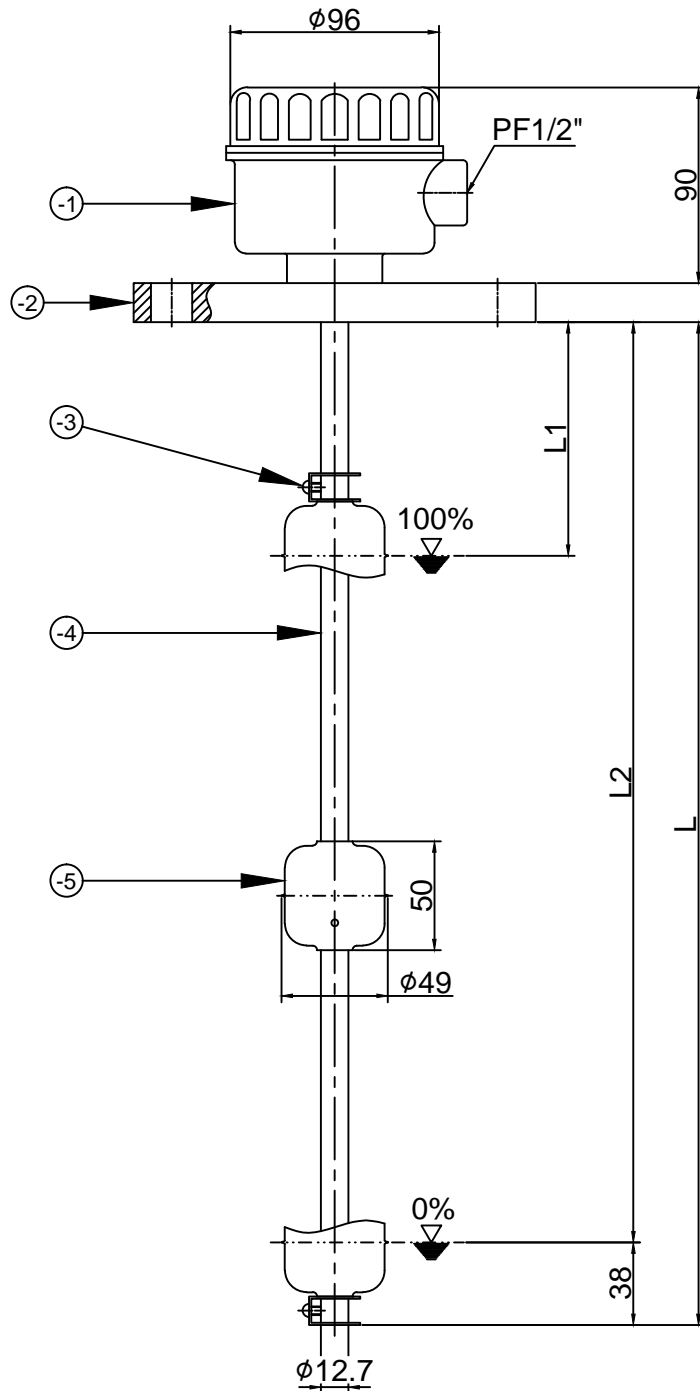

배부처

(UNIT:mm)

L	L1	L2	-	-
-5	FLLOAT	1	SUS304	
-4	PIPE	1	SUS304	
-3	STOPPER	2	SUS304	
-2	FLANGE	1	SUS304	
-1	HEAD	1	A.B.S	
1	DT-200S2	1SET	-	
ITEM NO.	PART NAME	QTY	MATERIAL	
SPECIFICATION				
MODEL NAME		DT-200S2		
PRESSURE		MAX.10Kgf/cm ²		
TEMPERATURE		MAX. -10 ~ +60°C		
APPLICATIONS		WATER, OIL, MEDICAL LIQUID		
OUTPUT SIGNAL		4~20mA		
INPUT SINGAL		DC24V		
MOUNTING METHOD		TOP		
MOUNTING SIZE		ORDER MADE		
MATERIAL		SUS304 / 316		
REMARKS :				
ORDER MADE(L1, L2, L=L2+38)				

NO	DATE	REVISION	APPD BY	BY	INITIAL	RELEASE	K.B.	HAN	TOLERANCES-UNLESS OTHERWISE SPECIFIED	DONG SUNG SENSORS CO.,LTD TEL:(02)2025-8988-9 FAX:(02)2025-8987				UNIT	MM, #CH	APPAR.																																																					
1	2014.01.27	INITIAL RELEASE	HAN						<table border="1"> <tr> <th>WORK SIZE</th> <th>TURN FINCHG DIST OF HOLE STR.</th> <th>MLDG. DIE CSTG. PRCL CSTG. DRAW.</th> <th>SHMET WELD GAS CTG.</th> <th>CSTG. FORG.</th> </tr> <tr> <td>OVER 1</td> <td>±0.1</td> <td>±0.2</td> <td>±0.3</td> <td>±0.5</td> </tr> <tr> <td>4</td> <td>±0.2</td> <td>±0.3</td> <td>±0.5</td> <td>±0.7</td> </tr> <tr> <td>16</td> <td>±0.3</td> <td>±0.4</td> <td>±0.7</td> <td>±0.9</td> </tr> <tr> <td>63</td> <td>±0.4</td> <td>±0.5</td> <td>±1.2</td> <td>±1.3</td> </tr> <tr> <td>250</td> <td>±0.6</td> <td>±0.8</td> <td>±1.5</td> <td>±1.6</td> </tr> <tr> <td>500</td> <td>±0.8</td> <td>±1.0</td> <td>±2.0</td> <td>±2.5</td> </tr> <tr> <td>1000</td> <td>±1.2</td> <td>±1.5</td> <td>±2.5</td> <td>±3.3</td> </tr> <tr> <td>2000</td> <td>±1.5</td> <td>±2.0</td> <td>±3.0</td> <td>±4.0</td> </tr> <tr> <td>ANGLE</td> <td>±.25°</td> <td>±.5°</td> <td>±1.0°</td> <td>±2.0°</td> </tr> </table>	WORK SIZE	TURN FINCHG DIST OF HOLE STR.	MLDG. DIE CSTG. PRCL CSTG. DRAW.	SHMET WELD GAS CTG.	CSTG. FORG.	OVER 1	±0.1	±0.2	±0.3	±0.5	4	±0.2	±0.3	±0.5	±0.7	16	±0.3	±0.4	±0.7	±0.9	63	±0.4	±0.5	±1.2	±1.3	250	±0.6	±0.8	±1.5	±1.6	500	±0.8	±1.0	±2.0	±2.5	1000	±1.2	±1.5	±2.5	±3.3	2000	±1.5	±2.0	±3.0	±4.0	ANGLE	±.25°	±.5°	±1.0°	±2.0°	SCALE	N/S	3RD ANGLE	3 각 법	REF. NO	참고도면	DWG. NO	-	도면번호	1/1
WORK SIZE	TURN FINCHG DIST OF HOLE STR.	MLDG. DIE CSTG. PRCL CSTG. DRAW.	SHMET WELD GAS CTG.	CSTG. FORG.																																																																	
OVER 1	±0.1	±0.2	±0.3	±0.5																																																																	
4	±0.2	±0.3	±0.5	±0.7																																																																	
16	±0.3	±0.4	±0.7	±0.9																																																																	
63	±0.4	±0.5	±1.2	±1.3																																																																	
250	±0.6	±0.8	±1.5	±1.6																																																																	
500	±0.8	±1.0	±2.0	±2.5																																																																	
1000	±1.2	±1.5	±2.5	±3.3																																																																	
2000	±1.5	±2.0	±3.0	±4.0																																																																	
ANGLE	±.25°	±.5°	±1.0°	±2.0°																																																																	
										DATE	2019.08.01.	2019.08.01.																																																									
										DRWN BY	J.H.HAN	DSND BY	K.B.HAN	CHKD BY		APPD BY		TITLE	DT-200S2																																																		
										표준		영시		도면																																																							